

How to connect hose fitting to tub and River Bed table



1
Hose shown connected at pump end.



2
Disconnect the male threaded hose fitting from the female quick connector.

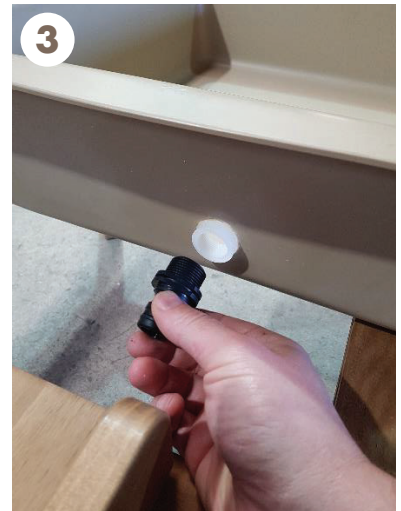

3
Screw the threaded male fitting into the tub.



4
Male fitting shown correctly in plastic tub.



5
Once tub is in place, simply connect the hose together. Ensure you hear it 'CLICK' into the locked position. To release, pull on the outer sleeve, just like a standard garden hose.